

# Albion Town site

Survey

Field notes County square Albion  
Cassia County, Idaho; Variation on  
Base line at Township corner Townships  
11 & 12 South; R 24 & 25 East, is  
180 + is so described on the plat, look-  
ing South, The south West corner of  
the square as finally located bears  
South East from the initial point  
of Town surveys, making an angle  
of  $84^{\circ} 57' 47''$  with the Government  
line running North & South through  
the middle of the section, and be-  
ing at a distance of 598.4 ft from  
said initial point, which is a rock  
marked 1/6 S located at the South  
East North East one-fourth North-west  
fourth section six Township 12 South  
Range 25 East, from which South-  
West corner of the County square be-  
fore mentioned the County square is  
laid off, a square Five acres be-  
ing 28,284 rods square subdivided  
into 21 lots 2 streets and one public-  
square field notes as follows:

Placed flag at peg corner. Bascom  
& Robinson's Store Set compass at peg  
at South East corner Stage Hotel  
turned a right angle and run  
100 feet East for street set peg & rock  
run from there East 28,284 rods  
setting pegs at regular intervals of 31  
feet, throwing the remainder into the  
street on the East, thence North 100  
feet to peg, thence West 28,186 rods,  
setting pegs at regular intervals

of 31 feet to north West corner block  
thence 100 feet south to place of begin-  
ning making 15 lots each 31 feet by  
100 feet.

Thence started at North East corner  
said block run north 51 ft set peg  
for street, run west at right angles  
28.186 rods set peg for same street  
51 feet wide having left pegs at  
100 + 150 feet for lot and street,

Started from last said starting point  
at the peg, 100 feet west of it and  
running north at right angles from  
last East & West line run, set off  
six lots 45 feet by 100 feet leaving  
the remainder on north for street.

Started from the North East corner  
County square run 100 feet west,  
thence 50 feet thence 19.095 rods  
to North West corner county square  
also of public square set peg-  
erratum set pegs at the corners  
of the public square and County  
square and all subdivisions thereof.  
The square run as I have said from  
the line described as running East  
from the peg at hotel a distance  
of 100 feet thence 28.284 feet thence  
28.284 rods. said line is a base  
from which the county square is  
laid off a square five acres a  
proof line run from North West  
to South West corner closing at  
28.284 rods.

Survey made,

John W. W. W.

Aug 1880

Respectfully

Frank Riblett

a Surveyor

Filed Oct. 7<sup>th</sup> 1880  
 And ordered Recorded  
 in Miscellaneous Book 1  
 Page 54  
 By The Board of County  
 Commissioners Oct. 22 1880  
 S. P. Weatherman  
 Co Recorder

Albion Town Site  
 County & Public Square, Cass Co. I.T.  
 North Street

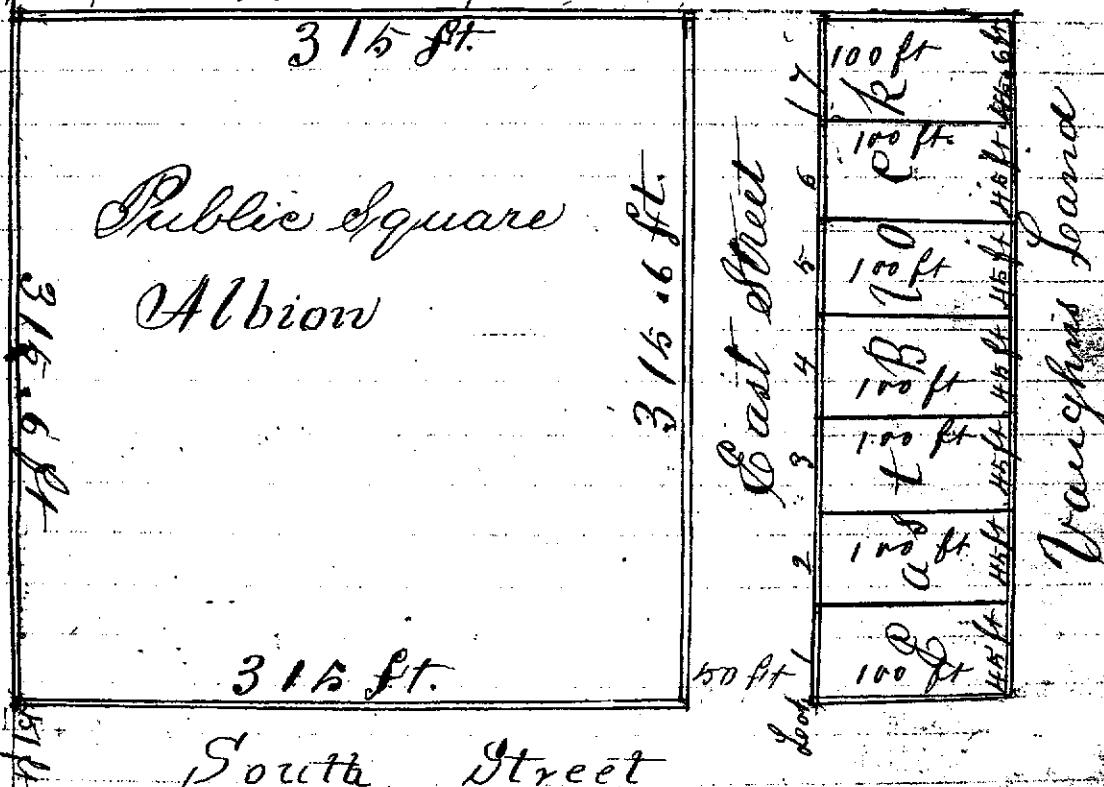

1	2	3	4	5	6	7	8	9	10	11	12	13	14	15
100 ft	100 ft	100 ft	100 ft	100 ft	100 ft	100 ft	100 ft	100 ft	100 ft	100 ft	100 ft	100 ft	100 ft	100 ft
31 ft	31 ft	31 ft	31 ft	31 ft	31 ft	31 ft	31 ft	31 ft	31 ft	31 ft	31 ft	31 ft	31 ft	31 ft

Filed Oct. 7<sup>th</sup> 1880, and Recorded  
 by request of The Board of Co Commissioners  
 Nov. 10<sup>th</sup> 1880.  
 S. P. Weatherman  
 Co Recorder  
 Cassia Co. Idaho Terr